

If you already have a Smart Life-account, proceed to step 4.

### Download the Smart life app and create an account

1. Connect your smartphone to the 2.4 GHz Wi-Fi network. Scan the QR code and/or download the 'Smart Life' app in the Apple App Store or Google Play Store on your smartphone.
2. Open the 'Smart Life' app and click on the 'New Account' button to create an account. If you already have an account, click on the button 'Log in with an existing account'. Please read the user agreement and privacy policy carefully and click 'Agree' to register your account.
3. Enter your email address and click on 'Get verification code'. A verification code will be sent to your email address. Enter the verification code and set a password. Click on 'Continue'.



### Connecting the STAS Wi-Fi smart LED

4. Make sure that the STAS multirail is connected to the power network. Click the fixture with the mounted STAS Wi-Fi smart LED at a desired location in the STAS multirail.
5. Open the 'Smart Life' app and click on 'Add Device' or the '+' in the top right corner of the page to add a device. Install a new device one at a time.
6. **Auto Scan**  
If you click on 'Auto Scan', the app will automatically detect the devices that are available to add. To do this, you must have the permissions for 'Access location', 'Turn on Wi-Fi' and 'Turn on Bluetooth'. Now you will see the STAS Wi-Fi smart LED in the screen and you only need to confirm it. If the 'Auto scan' mode doesn't work, you can choose 'Add manually'.
7. **Add manually (1)**  
Click on 'Add manually'. Select "Lighting" from the categories page. Select the device type 'Light source (Wi-Fi)'. Enter the password for your Wi-Fi network on the page that appears. Select the STAS Wi-Fi smart LED.
8. If the STAS Wi-Fi smart LED is connected properly, it will flash quickly. The device is in configuration mode. If this is the case, click on 'Confirm the light is blinking rapidly'. If the STAS Wi-Fi smart LED doesn't flash, remove the plug of the STAS multirail from the socket and switch the power supply on as follows: "on-off-on-off-on" in the socket. The lamp will now restart and the STAS Wi-Fi smart LED will start blinking. (2)
9. The STAS Wi-Fi smart LED is now connected. You can easily add multiple STAS Wi-Fi smart LEDs or other smart devices by repeating the steps above.

(1)

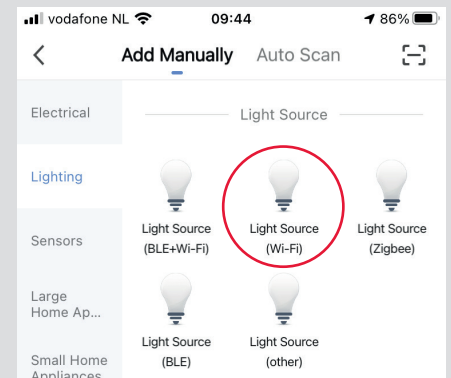

(2)

#### Reset the device first.

If the light is blinking rapidly, pls skip the reset step:

- ① Power on the device;
- ② Turn on-off-on-off-on (Subject to the user manual);
- ③ Ensure the light is blinking rapidly;

Note: please complete the network distribution within 3 minutes after resetting the device.

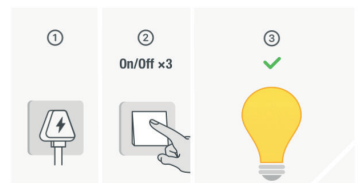

- Confirm the light is blinking rapidly;

Volgende

## Setting up the STAS Wi-Fi smart LED

### Rename a device

- Click on the STAS Wi-Fi smart LED and continue by clicking on the pencil to edit the settings. Here you can enter a name. This name will also be used by Amazon Alexa and Google home\*.

### Creating a group

- Click on the pencil  next to the STAS Wi-Fi smart LED to edit the device. Click here on 'Create group' (3). Give the group a name and check the boxes of the connected devices that may belong to this group. Now you can control all devices belonging to this group at the same time.

### Setting up a voice command

- Click the microphone icon to set up voice commands. \*Configuring the STAS Wi-Fi smart LED with Amazon Alexa and Google home does not take place in the Smart Life app. Use the manuals of Amazon Alexa and Google home instead.

### Setting the intensity, colour, scene or timer

- When you click on the STAS Wi-Fi smart LED, you will see various options at the bottom (4). With the options 'White', 'Colour' and 'Scene' you can set brightness, colour and different atmospheres. With the 'Timer' option you can create a schedule so that the devices turn on or off whenever you want.

(3)

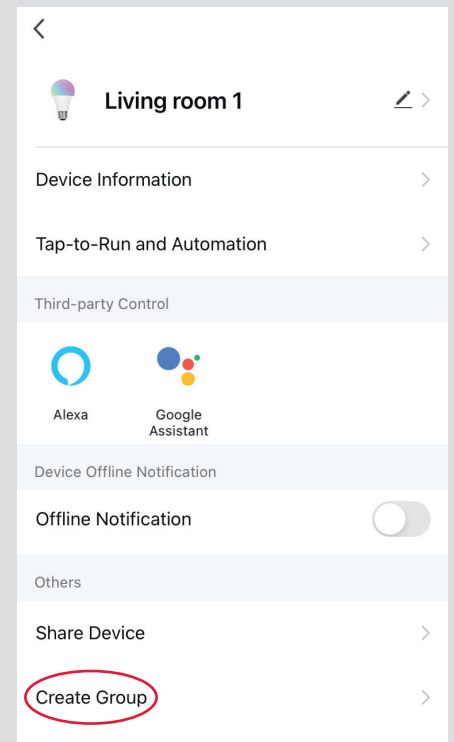

(4)

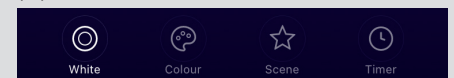

## Connecting the STAS Wi-Fi smart LED with remote control

- Follow all the first steps for connecting the STAS Wi-Fi smart LED in the Smart Life app.
- Install the batteries in the remote control.
- Switch the power supply of the STAS multirail off and on once.
- Press and hold the ON button on the remote control. The STAS Wi-Fi smart LED and the light on the remote control will both flash slowly. As soon as the connection has been established, the STAS Wi-Fi smart LED will light up brightly. Continue to hold the ON button until the STAS Wi-Fi smart LED returns to normal as it was set via the app. The light on the remote control and the STAS Wi-Fi smart LED will then briefly flash 3 times. The connection is now complete. If the distance between the lamps is not too great, all lamps can be connected at once. If this does not work, then the above steps must be followed for each lamp.

### Disconnecting the STAS Wi-Fi smart LED with remote control

- Press the OFF button on the remote control for 5 seconds until the light on the remote control turns off. The STAS Wi-Fi smart LED is now disconnected from the remote control.